

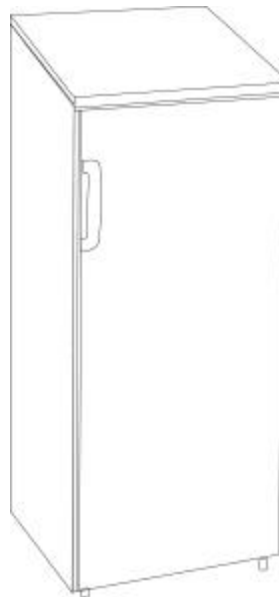

FREEZER

FR 650

OWNER'S MANUAL



IMPORTANT SAFETY INSTRUCTIONS

⚡ WARNING ⚡	Follow these basic precautions to reduce the risk of fire, electrical shock, or injury when using your appliance,
<ul style="list-style-type: none">• Read all instructions before using the appliance.• DANGER: Risk of child entrapment. Discarded or abandoned appliances are still dangerous. . . even if they will “just sit in the garage a few days.”• Before you throw away your old appliance : Take off the doors. Leave the drawers in place so that children cannot easily climb inside.• Never allow children to operate, play with, or crawl inside the appliance.• Never clean appliance parts with flammable fluids. The fumes can create a fire hazard or explosion.• Do not store or use gasoline or any other flammable vapors and liquids in the vicinity of this or any other appliance. The fumes can create a fire hazard or explosion.• This appliance contains CFCs, which may cause an adverse environmental impact on the ozone layer. When disposing of the appliance , please contact your local waste disposal department for advice on safe disposal. <p style="text-align: center;">-Save these instructions-</p>	

TECHNICAL INFORMATION

Input Power(W)	120
Refrigerant (g)	R134a 130g
Total Storage Volume(cuft)	6.3cuft
Rated Voltage(V)	115
Rated Frequency(Hz)	60

INSTALLATION INSTRUCTIONS

BEFORE USING YOUR APPLIANCE

- Remove the exterior and interior packing.
- Check to be sure you have all of the following parts:
 - 5 Drawers
 - 1 Top storage compartment
 - 1 Door Handle
 - 2 Screws for the handle
 - 2 Covers for the screws
 - 1 Owner’s Manual

- Before connecting the appliance to the power source, let it stand upright for approximately 2 hours. This will reduce the possibility of a malfunction in the cooling system from handling during transportation.
- Clean the interior surface with lukewarm water using a soft cloth.

INSTALLING YOUR APPLIANCE

- This appliance is designed to be free standing only, and should not be recessed or built-in.
- Place your appliance on a level floor that is strong enough to support the appliance when it is fully loaded. To level your appliance, adjust the front leveling leg at the bottom of the appliance.
- Allow 5 inches of space between the back and sides of the appliance, which allows the proper air circulation to cool the compressor.
- Position the appliance away from direct sunlight and sources of heat (stove, heater, radiator, etc.). Direct sunlight may affect the acrylic coating and heat sources may increase electrical consumption. Extreme cold ambient temperatures may also cause the appliance not to perform properly.
- Avoid placing the appliance in moist areas.
- Plug the appliance into an exclusive, properly installed-grounded wall outlet. Do not under any circumstances cut or remove the third (ground) prong from the power cord. Any questions concerning power and/or grounding should be directed toward a certified electrician or an authorized Equator Products service center.

ELECTRICAL CONNECTION

⚡ Warning ⚡

- Improper use of the grounded plug can result in the risk of electrical shock. If the power cord is damaged, have it replaced by an electrician or an authorized service agent

- This appliance should be properly grounded for your safety. The power cord of this appliance is equipped with a three-prong plug which mates with standard three prong wall outlets to minimize the possibility of electrical shock.
- Do not under any circumstances cut or remove the third ground prong from the power cord supplied. For personal safety, this appliance must be properly grounded.
-
- The cord should be secured behind the appliance and not left exposed or dangling to prevent accidental injury.
-
- The appliance should always be plugged into its own individual electrical outlet which has a voltage rating that matches the rating label on the appliance. This provides the best performance and also prevents overloading house wiring circuits that could cause a fire hazard from overheated. Never unplug the appliance by pulling the power cord. Always grip the plug firmly and pull straight out from the receptacle. Repair or replace immediately all power cords that have become frayed or otherwise damaged. Do not use a cord that shows cracks or abrasion damage along its length or at either end. When moving the appliance, be careful not to damage the power cord.

Installing the Door Handle

- 1. Remove the 2 plastic screws from the door.

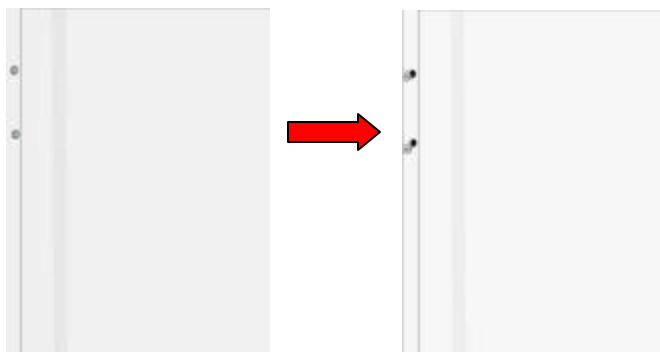

- 2. Take out the door handle, which is packed inside the freezer, and attach it to the door with the screws you have just removed. Cover the screws with the plastic screw covers.

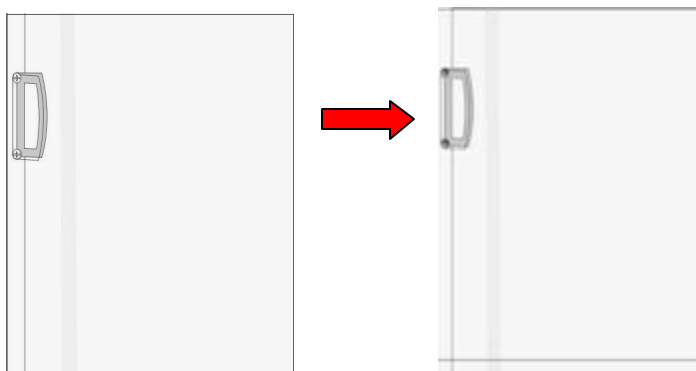

- Door handle screws and caps are provided.



Reverse the door swing

- Ensure the Appliance is unplugged and empty.
- Adjust the two levelling feet to their highest position.
- We recommend you have someone to assist you.

Tools required

- Phillips style screwdriver
- Flat bladed screwdriver

Note: to take the door off it is necessary to tilt the Appliance backward. You should rest the Freezer on something solid and place something under the rollers so that it will not slip during the door change process.

DO NOT lay the Appliance completely flat as this may damage the coolant system.



1. Undo the screws and remove the hinge bracket from the base. A spanner may be required to loosen the bolts first.

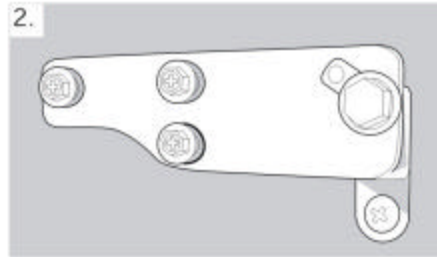

2. Remove the screws and adjustable foot from the opposite side and fit back to where the hinge bracket was located.

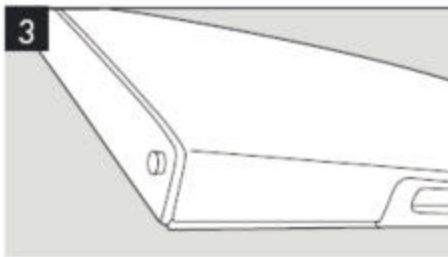

3. Slide the door down and off the top hinge pin and lift away from the appliance.

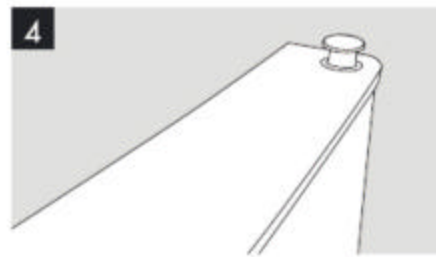

4. Remove the hinge bush at the top of the door and swap it with the blanking plate on the other side. Repeat with the hinge bush and blanking plate on the bottom of the door.



5. Using a screw driver, remove the pin from the top bracket. Replace it on the opposite bracket. Ensure the pin is secure.

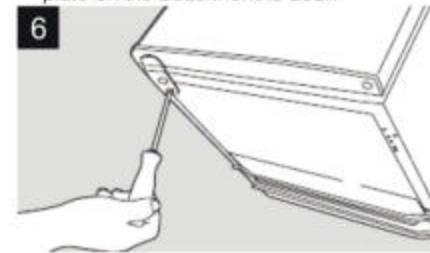

6. Slide the door on to the top hinge, ensuring it is all the way up. Screw the bottom hinge into place on the new side and replace the adjustable feet.

7. Check that door is aligned horizontally and vertically and that the seals are closed on all sides before finally tightening the bottom hinge. Re-adjust the levelling feet.

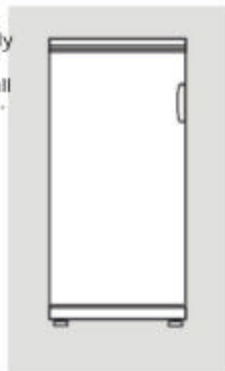

Temperature Control

- The temperature in the freezer is controlled by the thermostat control knob inside the freezer. Turn the thermostat control knob up or down to regulate the temperature inside the freezer. The markings on control knob indicated the “MIN, NOR, MAX and OFF” for the different temperature grades. The temperature decreases with position MIN being the warmest and position MAX being the coldest.
- Set the control to position NOR for normal use, but you may set the control to other positions if you find NOR is too cold or too warm.
- When using the freezer for the first time or after defrosting, turn the temperature control to set MAX for at least two hours before introducing the food to be stored.

Defrosting

- Unplug the appliance and open the door.
- Remove all food from the freezer to a cool place.
- Defrost using a plastic scraper or let the temperature rise naturally until the frost melts.
- Then wipe away the remaining ice and water.
- After defrosting, plug the freezer back into the wall socket.

CARE AND MAINTENANCE

CLEANING YOUR APPLIANCE

- Unplug the appliance, and remove the drawers.
- Wash the inside surfaces with a warm water and baking soda solution. The solution should be about 2 tablespoons of baking soda to a quart of water.
- Wash the drawers with a mild detergent solution.
- The outside of the appliance should be cleaned with mild detergent and warm water.
- Wring excess water out of the sponge or cloth before cleaning the area of the controls, or any electrical parts.
- Wash the outside cabinet with warm water and mild liquid detergent. Rinse well and wipe dry with a clean soft cloth.

CAUTION:

Failure to unplug the appliance could result in electrical shock or personal injury.

POWER FAILURE

Most power failures are corrected within a few hours and should not affect the temperature of your appliance if you minimize the number of times the door is opened.

NOTE: If the unit is unplugged, has lost power, or is turned off; you must wait 3 to 5 minutes before restarting/reconnecting the unit. If you attempt to restart before this time delay, the appliance will not start.

VACATION TIME

- **Short vacations:** Leave the appliance operating during vacations of less than three weeks.
- **Long vacations:** If the appliance will not be used for several months, remove all items and unplug the power cord. Clean and dry the interior thoroughly. To prevent odor and mold growth, leave the door open slightly, blocking it open if necessary.

MOVING YOUR APPLIANCE

- Securely tape down all loose items inside your appliance.
- Turn the leveling screw up to the base to avoid damage.
- Tape the doors shut.
- Be sure the appliance stays secure in the upright position during transportation. Also protect the outside of appliance with a blanket or similar item.

ENERGY SAVING TIPS

- The appliance should be located in the coolest area of the room, away from heat producing appliances, and out of the direct sunlight.

TROUBLESHOOTING GUIDE

You can solve many common appliance problems easily, saving you the cost of a possible service call. Try the suggestions below to see if you can solve the problem before calling the servicer.

PROBLEM	POSSIBLE CAUSE
Appliance does not operate.	Not plugged in. The circuit breaker tripped or a blown fuse.
Appliance is not cold enough.	Check the temperature control setting. Make sure the unit is away from direct sunlight and heat sources. Make sure there is adequate air flow at the rear. The door is opened too often. The door is not closed completely. The door gasket does not seal properly.
Turns on and off frequently.	The room temperature is hotter than normal. The door is opened too often. The door is not closed completely. The temperature control is not set correctly. The door gasket does not seal properly.
The appliance seems to make too much noise.	The appliance is not level.
The door will not close properly.	The appliance is not level. The door was reversed and not properly installed. The gasket is dirty. The shelves are out of position.

The following characteristics should not be looked upon as a problem.

- A gentle trickling sound caused by the flow of the refrigerant is normal.
- Compressor operating at high temperature.

CONTACT INFORMATION

SERVICE & SUPPORT:

custserv@ApplianceDesk.com

(800) 776-3538

**ConServ Appliances
2801 W Sam Houston Parkway N, Suite130
Houston, TX 77043-1611
Phone: 713-933-1474 Fax: 713-933-1475**

All rights reserved.

Manual subject to change without notice